

Type 2279 Duratran® Transmitter Available With PLUS!™ Performance Option



The Duratran® transmitter introduces a unique electronic pressure-indicating transmitter with direct mechanical indication, suitable for aggressive environments and process fluids.

The Duratran transmitter combines out-standing, reliable local indication that functions without the need for external power with a stable, self-contained 4-20ma transmitter in a hermetically sealed corrosion proof case.

The wide selection of system materials and corrosion-proof housing meets application requirements in a number of industries. These include chemical processing, petrochemical and refining plants, electric and gas utilities, waste-water, pulp and paper, and other industrial applications.

This electronic pressure-indicating transmitter promises increased service life and long-term stability.

And, users can now integrate pressure gauge installations into safety and data acquisition systems.

Principle of Operation

The pressure gauge function uses technology from our Duragauge® pressure gauge with its easy calibration rotary movement and stable pressure element.

The transmitter portion of this instrument operates with photo-electronics that continually sense the position of a light, rugged vane moving directly with the tip of the Bourdon tube that drives the mechanical-indicating mechanism. The opto-electronic system is friction-free and self-regulated through electronic feedback to cancel effects of time and temperature. There are no glues or molecular bonds to creep and degrade accuracy over time. The large measurement motion derived from the basic sensor is inherently linear, simplifying the electronic circuitry and adding reliability.

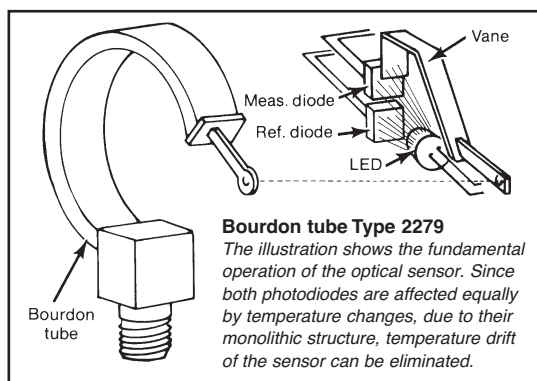

PRODUCT SPECIFICATIONS

Model Number:	2279
Service:	Liquid, gas or vapor
Dial Size:	4½" analog dial indication in engineering units
Case:	Solid front, black phenol hermetically sealed
Ring:	Threaded, glass-filled Polypropylene
Mounting:	Stem, surface, flush (with 1278 M ring)
Bourdon Tube and Socket Material:	316 Stainless Steel or Monel
Pressure Connection:	½ NPT
Window:	Laminated safety glass
Calibration:	Transmitter – Span and zero adjustment on dial Gauge – Zero adjustment with micrometer pointer
Electrical Connection:	30" #18 wire AWG, ½ NPT liquid tight conduit connection at case
Weight:	3 lbs
Ranges:	See Table Below
Output:	4-20mA, 2 wire
Power Supply:	12/40 Vdc
Zero Adjustment:	±20% of full scale
Span Adjustment:	±10% of full scale
Temperature Limit:	–40°F to 160°F
Over Pressure Limits:	130% of range without damage to tube
Humidity Limits:	Up to 90% relative humidity non-condensing
Signal Damping:	Fixed electronic damping time constant of 0.2 seconds
Accuracy:	±0.5% including linearity, hysteresis and repeatability
Stability:	±0.25% F.S. for 6 months
Temperature Effect:	Less than 0.02% of span/°F
Mounting Position Effect:	Vertical mounting recommended. May be re-zeroed to correct error in other positions
Loop Resistance:	See loop resistance chart on back.

STANDARD RANGE TABLE*

PSI	METRIC		
	kg/cm²	bar	kPa
Vacuum			
Compound			
0/12	0/1	0/1	0/100
0/15	0/1.6	0/1.6	0/160
0/30	0/2.5	0/2.5	0/250
0/60	0/4	0/4	0/400
0/100	0/6	0/6	0/600
0/160	0/10	0/10	0/1000
0/200	0/16	0/16	0/1600
0/300	0/25	0/25	0/2500
0/400	0/40	0/40	0/4000
0/600	0/60	0/60	0/6000
0/800	0/100	0/100	0/10,000
0/1000	0/160	0/160	0/16,000
0/1500	0/250	0/250	0/25,000
0/2000	0/400	0/400	0/40,000
0/3000	0/600	0/600	0/60,000
0/5000	0/1000	0/1000	0/100,000
0/10,000	0/1600	0/1600	0/160,000

Dual scale and receiver gauge dials available on application

Type 2279 Duratran® Transmitter Available With *PLUS!*™ Performance Option

DIMENSIONS

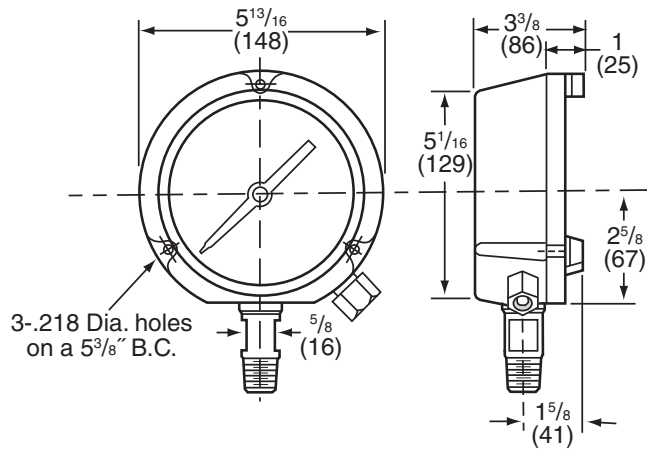

LOOP RESISTANCE CHART

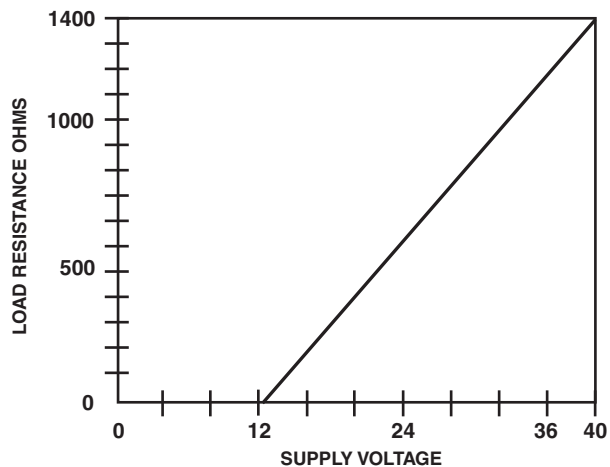

HOW TO ORDER:

45 2279 SSH 04L XPD 100#
 Dial Size: $4\frac{1}{2}$ " : _____
 Case Type Number: 2279 _____
 Bourdon System: _____
 Connection Size & Location: $\frac{1}{2}$ NPT (04) Lower (L) _____
 Variation _____
 Range: 0/100 psi (See page 1) _____